



AX1772

Adventure skid plate

BMW F900GS

What's in the box ?

- 1 PM01-04-296 - Front left fixation
- 1 PM01-04-297 - Front middle fixation
- 1 PM01-04-298 - Front right fixation
- 2 PM01-04-299 - Rear fixation
- 1 PM01-04-300 - Bottom plastic block
- 1 NE04-01-283 - Sticker
- 2 NE01-06-013 - TH 6x40mm screws
- 2 NE01-02-005 - TFHC 6x35mm screws
- 2 NE10-01-004 - Alloy spacers
- 4 NE01-04-002 - Clamped bolts
- 4 NE01-02-004 - TFHC 6x30mm screws
- 3 NE01-02-003 - TFHC 6x25mm screws
- 7 NE01-04-003 - EM6F bolts
- 11 NE01-03-001 - M6 Washers
- 2 NE01-05-008 TCHC 6x45mm screws
- 2 NE01-05-001 TCHC 6x30mm screws
- 2 NE13-01-001 - 8mm foam stickers



The paper instructions may be limitless, scan the QR code to watch the tutorial video online.



Assembling instructions

Approximate time of assembly: 30 minutes.

A skid plate is made to protect the vital components of your bike and does not have a « life warranty ». However, production default may happen and we cover it during the first year of use.

In case of premature breakage, please write to contact@axpracing.com

Follow the steps



Stick the foam on each side of the skid plate and on the plastic block.

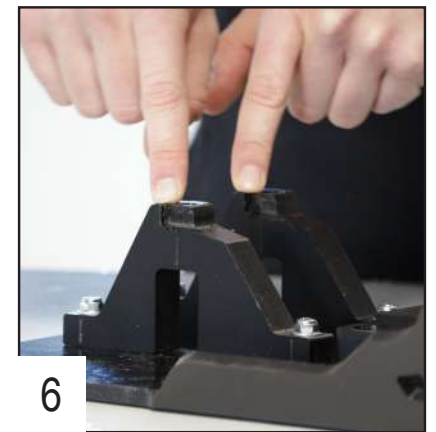

Place the plastic block on the bottom of the skid plate using 3 TFHC 6x25mm screws + M6 washers and bolts then tighten.

Place the 2 rear fixations in plastic using 4 TFHC 6x30mm screws. The machined sides must be on the right.



7

Tighten the screws.



8

Place the 4 clamped bolts inside the front fixations.



9

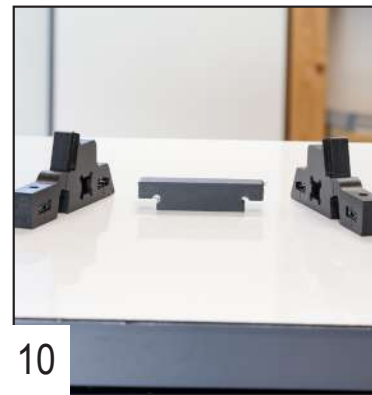

10

Clip the front middle block inside the fixations.

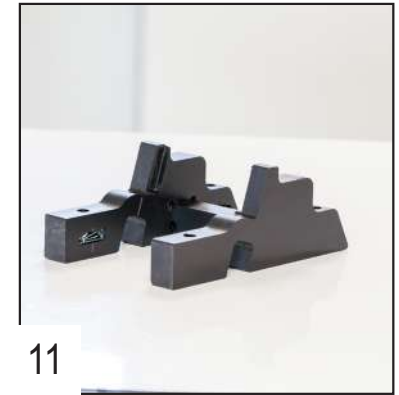

11

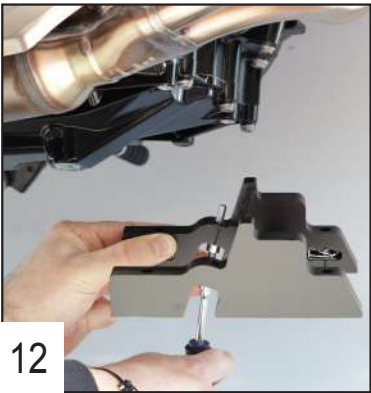

12

Use 2 TCHC 6x30mm screws + M6 washers to fix the front fixation directly on the engine block and tighten.



13



14

Place the skid plate under the frame.

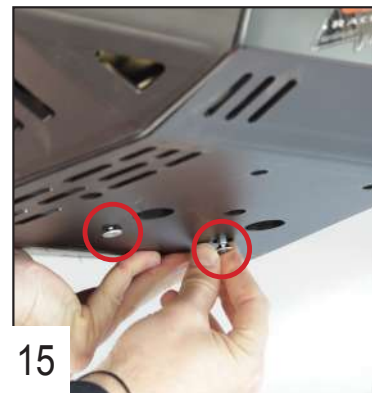

15

Place 2 TFHC 6x35mm screws in the middle holes to keep the plate in place, do not tighten.

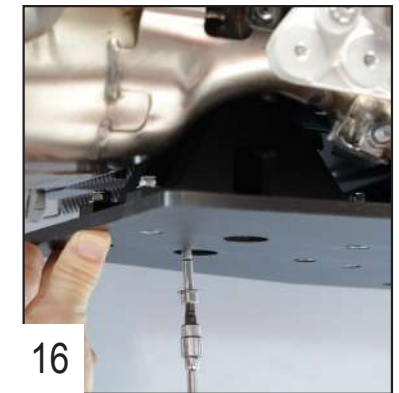

16

Place 2 TCHC 6x45mm screws + M6 washers in the rear fixations without tightening.



17

Put the alloy spacers in the front holes, then place 2 TH 6x40mm screws without tightening.



18

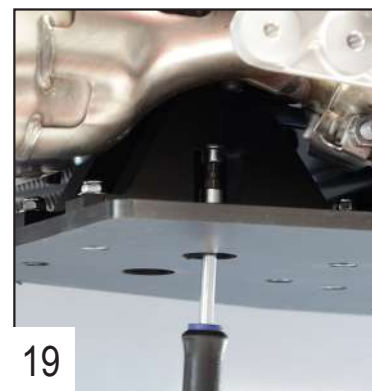

19



20

Tighten all the screws, starting with the rear screws, then the middle and the front.



21