



AX1766

Adventure skid plate

CFMoto 450 MT / IBEX 450

What's in the box ?

- 1 NE04-01-282 - Sticker
- 1 NE04-01-288 - Small sticker
- 1 NE13-01-001 - 8mm foam pad
- 1 PM01-04-302 - Rear plastic fixation
- 2 PM01-06-093 - Front brackets
- 4 NE10-01-009 - Shoulder rings D8,5
- 4 NE01-02-016 - TFHC 8x30mm screws
- 1 NE01-02-004 - TFHC 6x30mm screws
- 1 NE01-02-003 - TFHC 6x25mm screws
- 2 NE01-04-003 - Em6f bolts
- 2 NE01-03-001 - M6 washers
- 2 NE01-02-023 - TFHC 6x12mm screws



The paper instructions may be limitless, scan the QR code to watch the tutorial video online.

Assembling instructions

Approximate time of assembly: 15 minutes.

A skid plate is made to protect the vital components of your bike and does not have a « life warranty ». However, production default may happen and we cover it during the first year of use.

In case of premature breakage, please write to contact@axpracing.com

Follow the steps



Cut the foam in two pieces and stick one on each side of the skid plate.

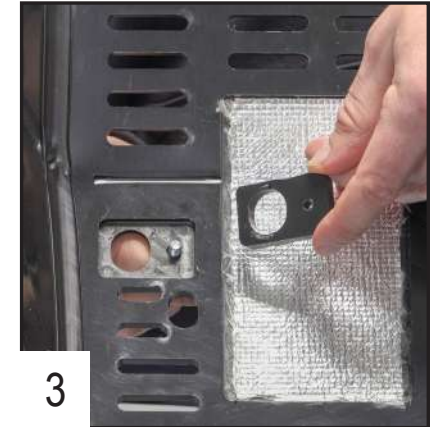

Put the front brackets in the machined places and use 2 TFHC 6x12mm screws.



Tighten the screws (auto drilling) and make sure to align the holes.

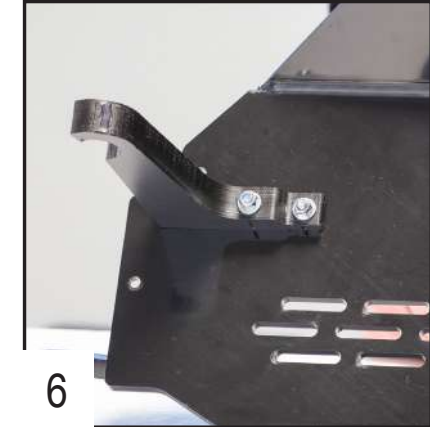
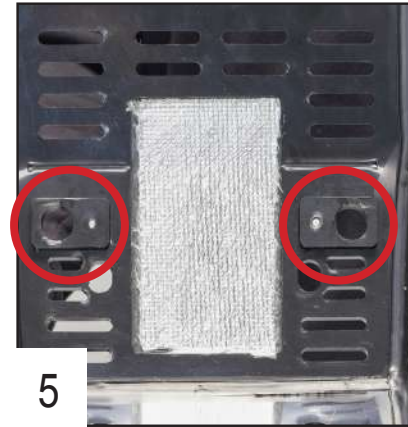

Place the rear bracket, make sure to use a TFHC 6x30mm screw in the longest hole and a TFHC 6x25mm screw in the smaller one.



7

Place the plate under the bike and clip the rear bracket on the frame tube.



8

Use 2 alloy spacers + 2 TFHC 8x30mm screws to fix the front of the plate. Do not tighten yet.

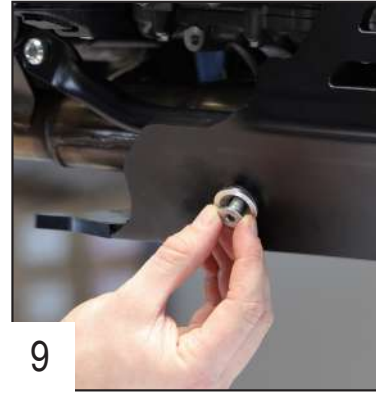

9

Place one alloy spacer + 1 TFHC 8x30mm screw on each side of the plate.



10

Tighten the rear and then the front screws.



11



12

Remove the rear screws and the spacers.



13

Insert the crash bars in the holes and use the OEM screw to fix the bar and the skid plate together to the frame.



14



15

If you want to fix the **OEM crash bars**, the fitment is the same, you just need to follow these instructions.

You're all ready to ride!