



AX1762

Xtrem skid plate
Sherco SEF450 / SEF500
Factory

Assembling instructions

What's in the box ?

- 2 NE01-11-001 - THF 6x25mm screws
- 3 NE01-04-002 - Clamped bolts
- 2 NE01-02-002 - TFHC 6x20mm screws
- 1 NE01-02-003 - TFHC 6x25mm screws
- 2 NE01-04-003 - EM6F bolts
- 2 NE01-03-001 - M6 washers
- 1 NE04-01-276 - Sticker
- 1 PM01-06-087 - Rear plate n°52



The paper instructions may be limitless, scan the QR code to watch the tutorial video online.



Approximate time of assembly: 15 minutes.

A skid plate is made to protect the vital components of your bike and does not have a « life warranty ». However, production default may happen and we cover it during the first year of use. In case of premature breakage, please write to contact@axpracing.com

Follow the steps !



Place one clamped bolt on the rear of the frame, and 2 on the front for the fixation.

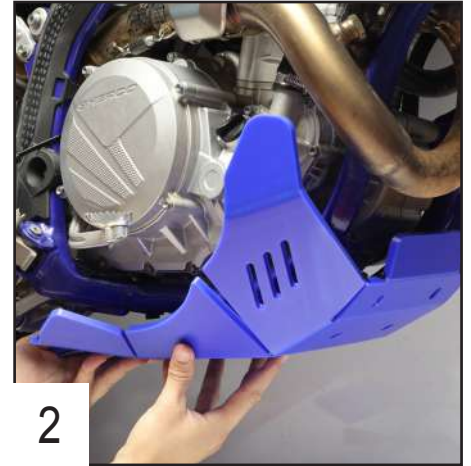

Place the skid plate under the frame to align the holes with the clamped bolts.

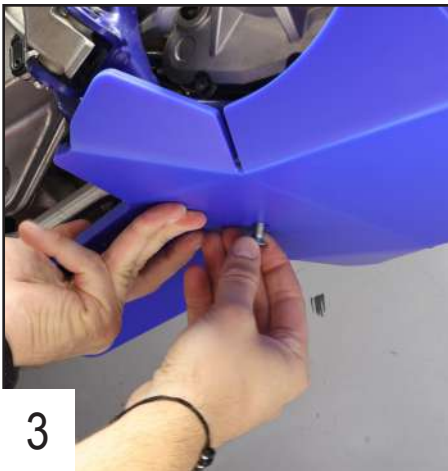

Place the TFHC 6x25mm screw in the rear hole.
Then tighten.

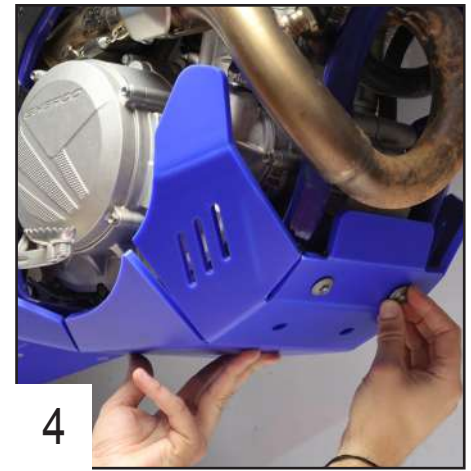
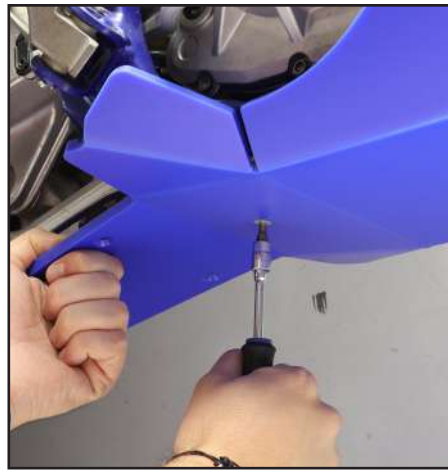

Place 2 THF 6x25mm screws
in the front holes.

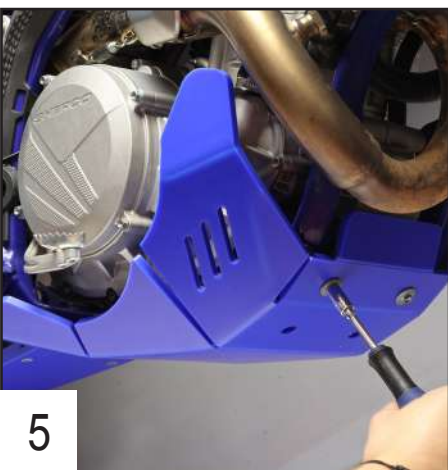

Tighten the screws.

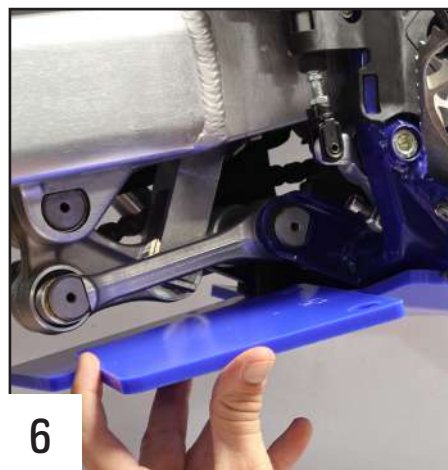

Place the linkage guard.

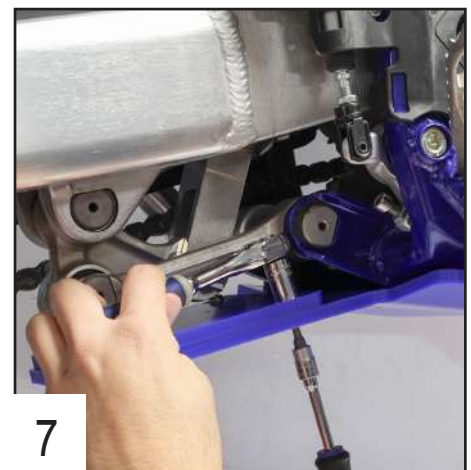

Fix the plate using 2 TFHC
6x20mm screws + M6 washers
and bolts.

You're all ready to ride !