



# AX1754

Xtrem skid plate  
Beta 350RR / 390RR /  
430RR / 480RR Racing

# Assembling instructions

## What's in the box ?

- 3 NE01-04-002 - Clamped bolts
- 3 NE10-01-004 - Alloy spacers
- 1 PM01-04-247 - Front fixation
- 1 PM01-04-284 - Rear fixation block
- 3 NE01-06-003 - TH 6x30mm screws
- 2 NE01-02-002 - TFHC 6x20mm screws
- 4 NE01-04-003 - EM6F bolts
- 2 NE01-03-001 - M6 washers
- 2 NE01-03-006 - M6 large washers
- 2 NE01-02-005 - TFHC 6x35mm
- 1 PM01-06-082 - 8mm plate n°49
- 1 NE04-01-269 - Black sticker



The paper instructions may be limitless, a tutorial video is available online to help you.

Scannez le QR code pour regarder la vidéo de montage.



Approximate time of assembly: 15 minutes.

A skid plate is made to protect the vital components of your bike and does not have a « life warranty ». However, production default may happen and we cover it during the first year of use. In case of premature breakage, please write to [contact@axpracing.com](mailto:contact@axpracing.com)

## Follow the steps !

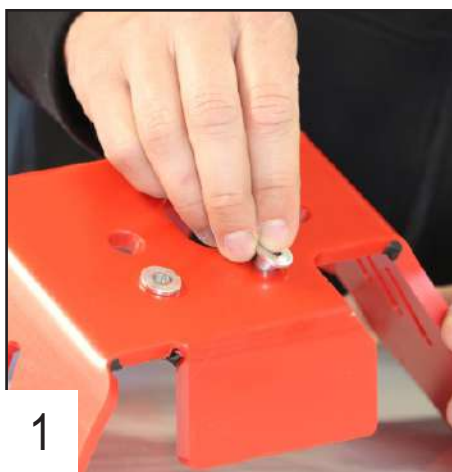

1

Place 2 alloy spacers in the front holes.

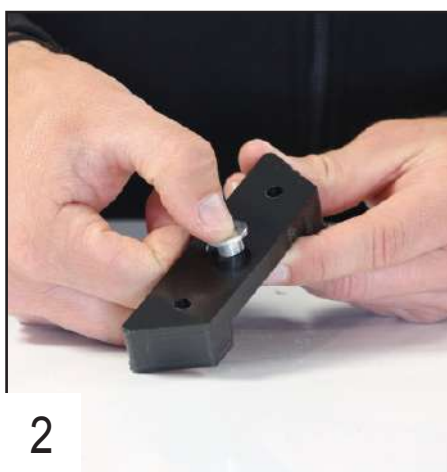

2

Place the alloy spacer in the rear fixation.

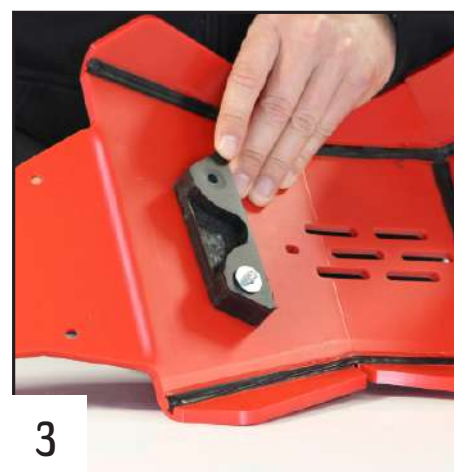

3

Fix the rear fixation using 2 TFHC 6x35mm screws + large washers and bolts.



4

Tighten the screws.



5

Place 2 clamped bolts in the front fixation.

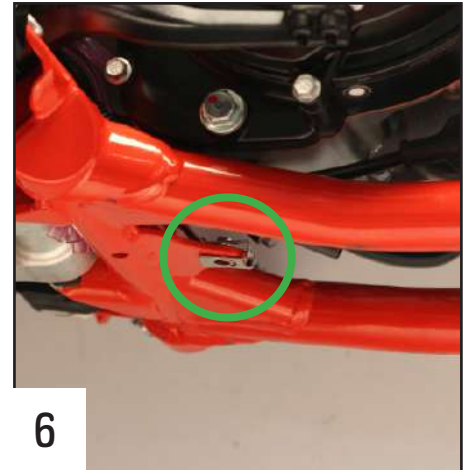

6

Place the clamped bolt directly on the frame, the flat side facing down.



7

Place the front fixation in the frame and clip it.



8

Place the skid plate and use a TH 6x30mm screw in the rear hole to maintain it, then tighten.



9

Place 2 TH 6x30mm screws in the front holes, then tighten. You can use the bigger hole to place the fixation correctly.



10

Pull the plate down to place the linkage guard.

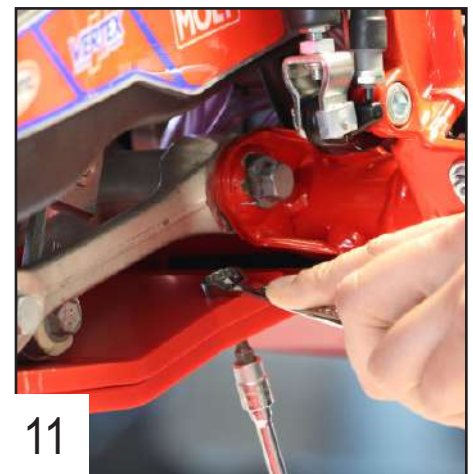

11

Fix the guard with 2 TFHC 6x20mm screws + washers and bolts.

**You're all ready to ride !**