



AX1723

Xtrem skid plate

KTM 450/500 EXCF 2024

Assembling instructions

What's in the box ?

- 1 PM01-06-060 - 8mm front plastic part
- 1 PM01-04-231 - 20mm front plastic part
- 1 PM03-04-113 - 4mm aluminium part
- 2 NE01-04-002 - Clamped bolts
- 2 NE10-01-004 - Alloy spacers
- 4 NE01-03-001 - M6 washers
- 2 NE01-04-003 - EM6F bolts
- 2 NE01-06-028 - TH 6x35 screw
- 2 NE01-02-002 - TFHC 6x20mm screws
- 1 NE01-02-001 - TFHC 6x16mm screws
- 1 NE04-01-253 - Sticker



The paper instructions may be limitless, scan the QR code to watch the tutorial video online.



Approximate time of assembly: 15 minutes.

A skid plate is made to protect the vital components of your bike and does not have a « life warranty ». However, production default may happen and we cover it during the first year of use.

In case of premature breakage, please write to contact@axpracing.com

Follow the steps !



1

Place two clamped bolts in the 20mm front plastic part.

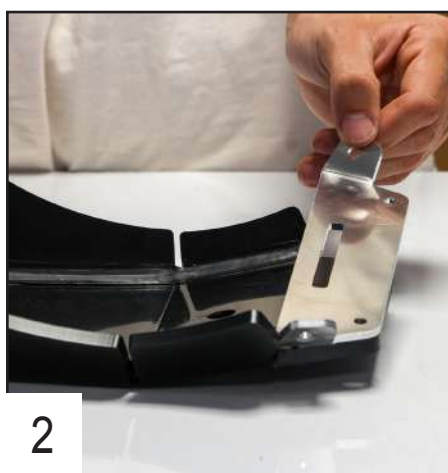

2

Place the aluminium part on the rear of the plate.

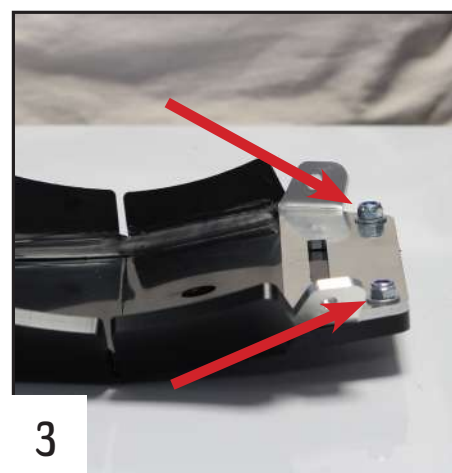

3

Place two TFHC 6x20mm screws + EM6F bolts and M6 washers.



4

Tighten the screws.

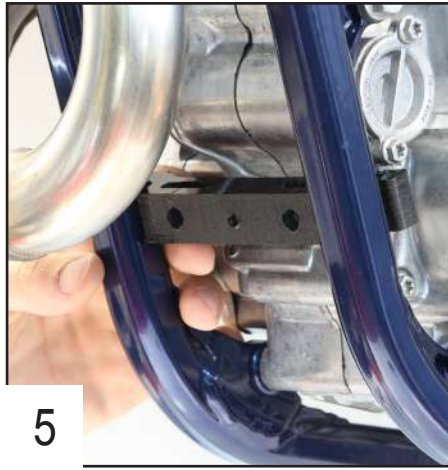

5

Place the 22mm plastic part on the front of the frame.

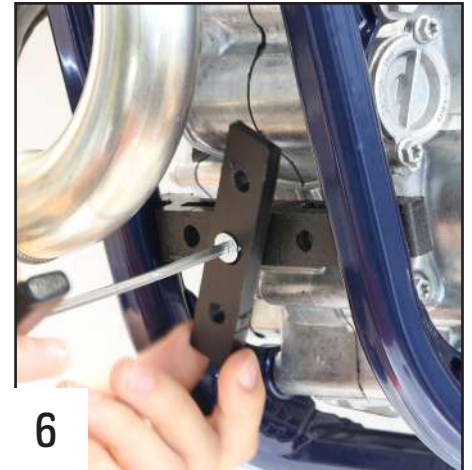

6

Use the 8mm plastic part and a TFHC 6x16mm screw to fix it on the frame.

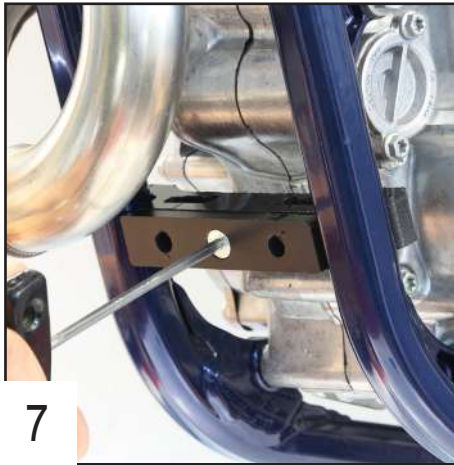

7

Adjust it in height so it rests on the welds of the frame and tighten the screw.

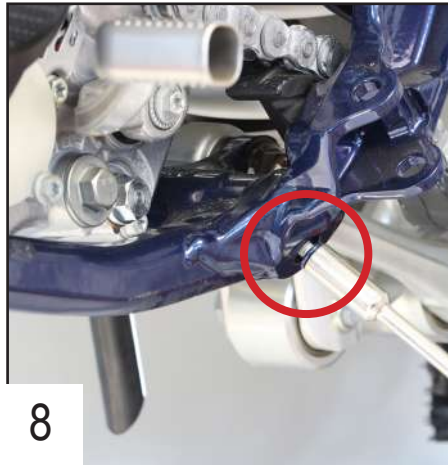

8

Remove the OEM screws on both sides.

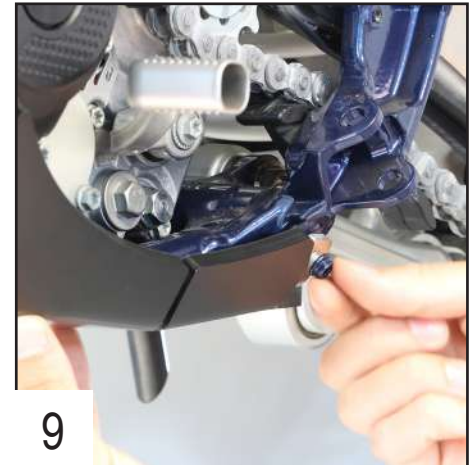

9

Place the plate on the bike and put the OEM screws back in place without tightening.

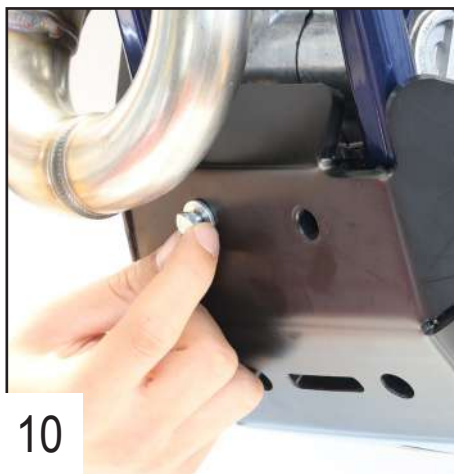

10

Place two TH 6x35mm screws + M6 washers in the front holes.



11

Tighten the front screws.

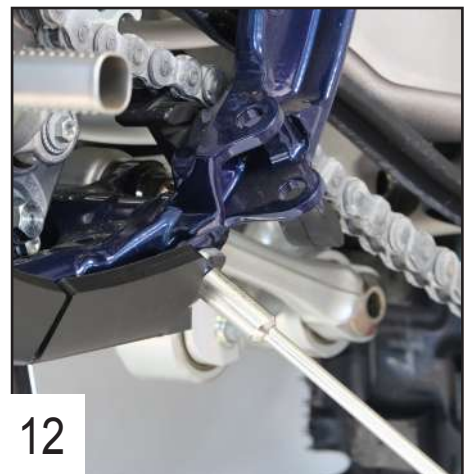

12

Tighten the screws on both sides.

You're all ready to ride !