



AX1721

Rear trailer arm guards

Polaris RZR XP1000 Sport

Assembling instructions

What's in the box ?

- 6 NE03-01-008 - Alloy spacers 40mm
- 8 NE01-01-006 - TBHC 8x40mm screws
- 10 NE01-04-001 - EM8F bolts
- 10 NE01-03-002 - M8 washers
- 2 NE01-01-017 - TBHC 8x30mm screws
- 12 NE01-01-009 - TBHC 6x20mm screws
- 12 NE01-03-001 - M6 washers
- 2 NE04-01-001 - Stickers
- 1 PM01-07-072 - Left mud guard
- 1 PM01-07-073 - Right mud guard



The paper instructions may be limitless, scan the QR code to watch the tutorial video online.



Approximate time of assembly: 30 minutes.

Rear trailer arm guards are made to protect the vital components of your SSV and do not have a « life warranty ». If you notice a defect on your rear trailer arm guards at reception, please write to contact@axpracing.com

Follow the steps



1

Place the arm guard in place.



2

Place the alloy spacer in the back hole.

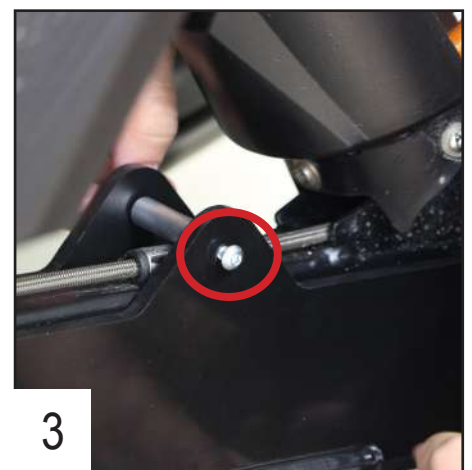

3

Use the TBHC 6x20mm screw + M6 washer to fix the spacer.



4

Place the 2 other alloy spacers in the holes and use the TBHC 6x20mm screws + M6 washer to maintain the spacers.

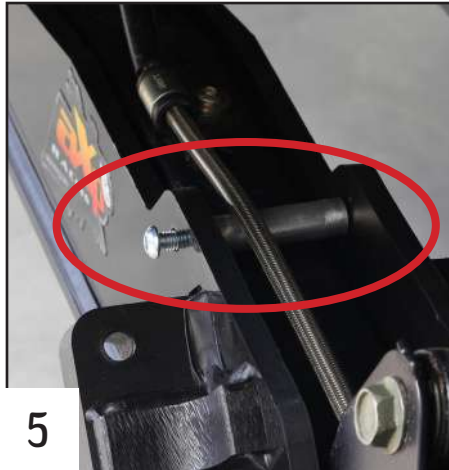

5

Make sure to place the middle spacer under the cable.

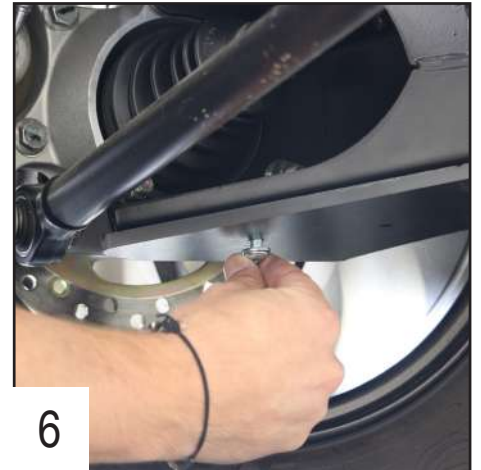

6

Use the TBHC 8x30mm screws + bolts and M8 washers to fix the guard on the back of the arm.



7

Tighten the screws.



8

Slide the mud guard under the arm.

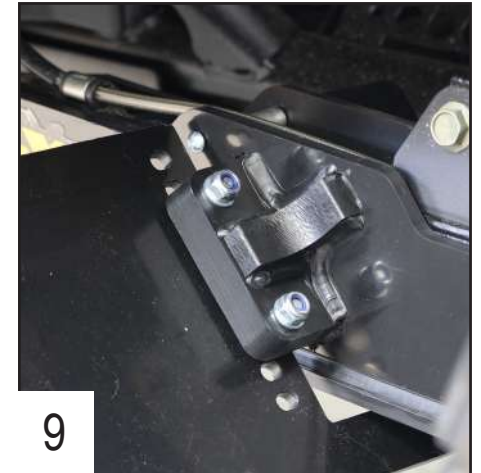

9

Choose the height and use the TBHC 8x40mm screws + bolts and washers to fix it.



10

Repeat the operation on the other side.

**You're
all ready
to ride !**