



# AX1720

## Radiator braces

### KTM 250/300 EXC/XCW

# Assembling instructions

## What's in the box ?

- 4 PM03-02-031 - 126mm spacers
- 4 NE01-02-001 - TFHC 6x16mm screws
- 8 NE01-01-001 - TBHC 6x16mm screws
- 4 NE01-01-009 - TBHC 6x20mm screws
- 8 NE01-03-001 - M6 washers



The paper instructions may be limitless, scan the QR code to watch the tutorial video online.



Approximate time of assembly: 30 minutes.

Radiator guards are made to protect the vital components of your bike and does not have a « life warranty ». If you notice a defect on your radiator guards at reception, please write to [contact@axpracing.com](mailto:contact@axpracing.com)

## Follow the steps



1

Place the beveled sides on the outside.

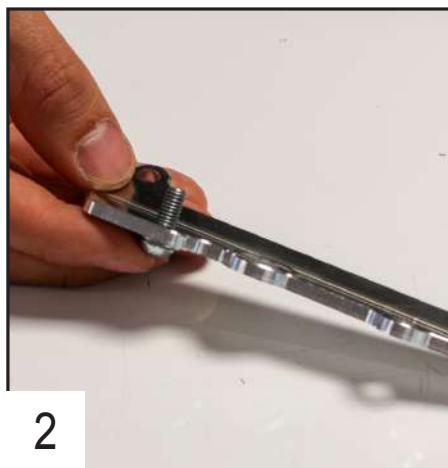

2

Place the TBHC 6x16mm screw on the 2 center holes of the longest aluminium part.



3

Place the 2 spacers on the 2 TBHC screws.

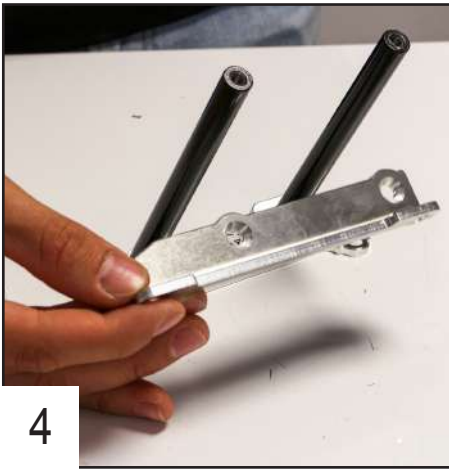

4

Place the smaller aluminium part on the other side of the spacers.

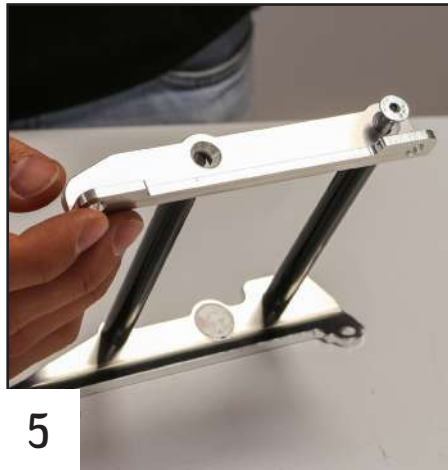

5

Place the TFHC 6x16mm screws in the 2 holes.

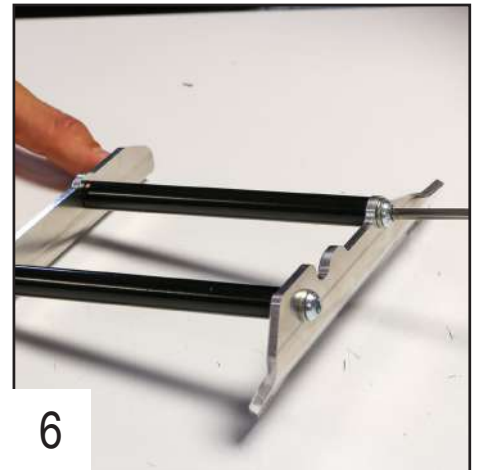

6

Tighten all the screws and repeat the operation on the other side.

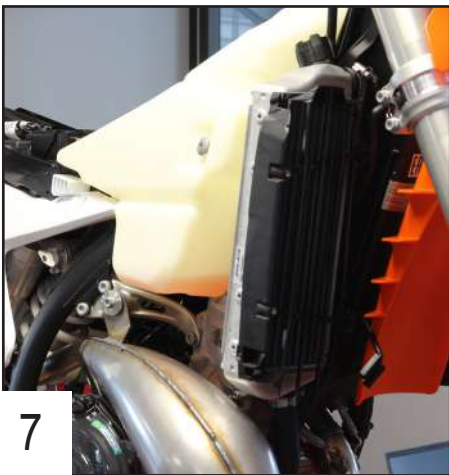

7

Remove the seat, the plastic covers and the horn.

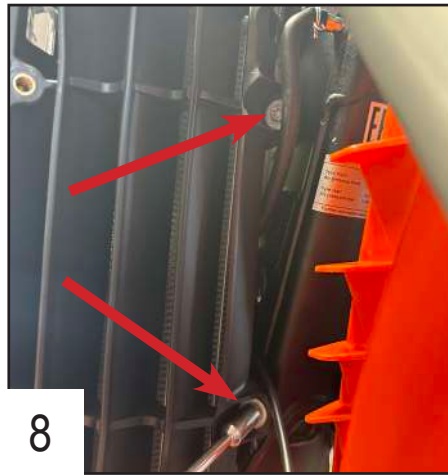

8

Remove the 2 OEM screws.

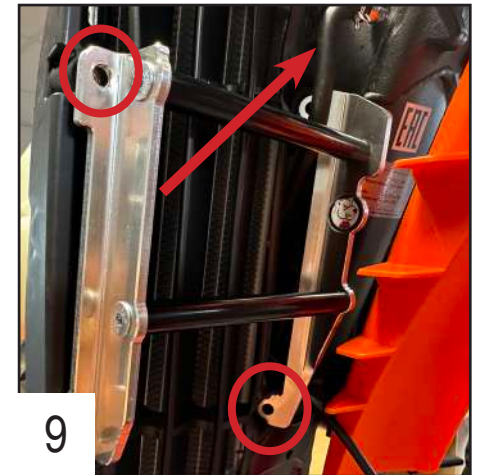

9

Place the guard on the radiator. Make sure to place it behind the cable and align it to the holes.

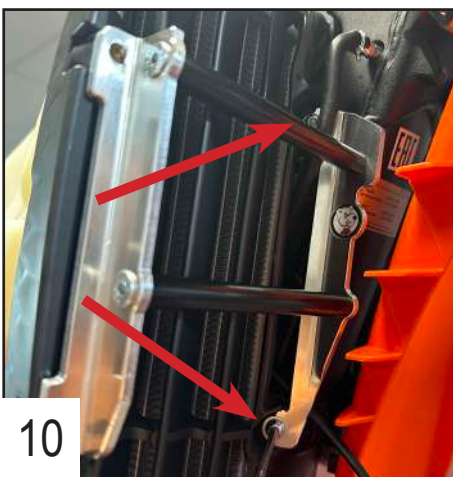

10

Place the 2 TBHC 6x16mm screws in the back holes without tightening them.



11

Put the plastic cover back on and place the plastic hole between the radiator and the guard.

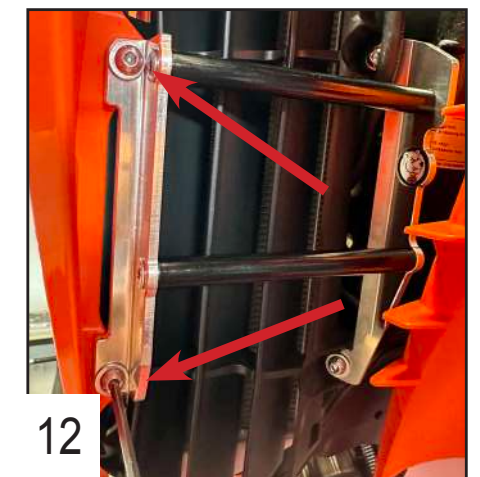

12

Place the TBHC 6x20mm in the 2 holes and tighten the four screws. Repeat the operation on the other side.

**You're all ready to ride !**