



AX1704

Adventure skid plate

Suzuki V-strom 800DE

What's in the box ?

- 1 PM03-04-123 - Front right fixation
- 1 PM03-04-124 - Front left fixation
- 1 PM03-04-125 - Aluminium rear fixation
- 1 PM01-06-078 - 8mm plastic part
- 1 PM01-04-273 - 20mm plastic part
- 1 PM01-06-079 - Mud guard
- 2 NE01-11-001 - Special screws
- 1 NE01-02-001 - TFHC 6x16mm screw
- 2 NE01-01-001 - TBHC 6x16mm screw
- 2 NE01-02-006 - TFHC 6x40mm screw
- 4 NE01-02-002 - TFHC 6x20mm screw
- 4 NE01-02-004 - TFHC 6x30mm screw
- 4 NE01-03-001 - M6 washers
- 4 NE01-03-006 - Large M6 washers
- 6 NE01-04-003 - EM6F bolts
- 4 NE01-04-002 - Clamped bolts
- 2 PM05-01-001 - Heat shield stickers
- 1 NE13-01-001 - Foam
- 1 NE04-01-251 - Sticker



The paper instructions may be limitless, scan the QR code to watch the tutorial video online.



Assembling instructions

Approximate time of assembly: 15 minutes.

A skid plate is made to protect the vital components of your bike and does not have a « life warranty ». However, production default may happen and we cover it during the first year of use.

In case of premature breakage, please write to contact@axpracing.com

Follow the steps

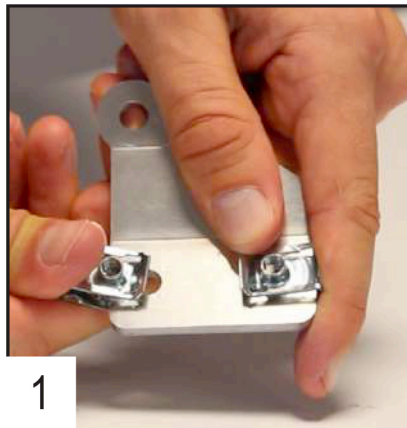

1
Insert the four clamped bolts in the two front fixations.

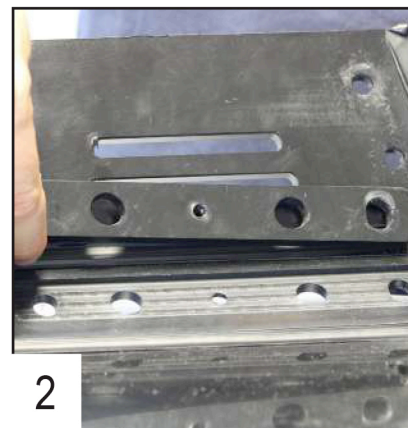

2
Place the 8mm plastic part in the machined spot, make sure to align the holes.

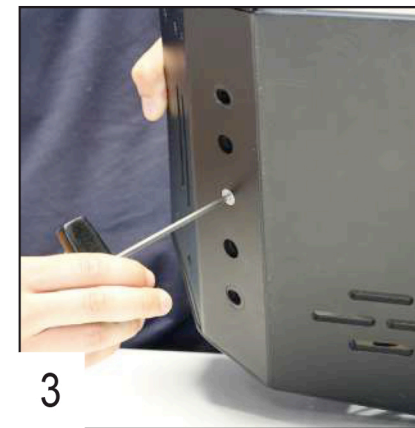

3
Place the TFHC 6x16mm screw to fix the plastic part and tighten.

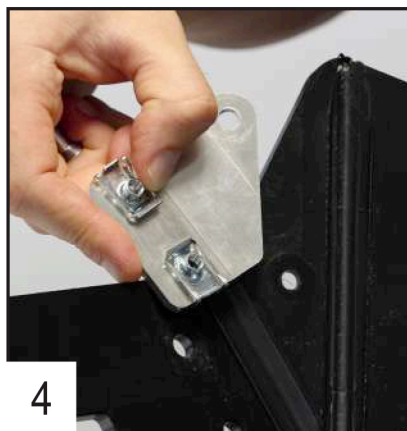

4
Place the front fixation on each corner of the skid plate.



5
Place the TFHC 6x20mm screw in the top hole.

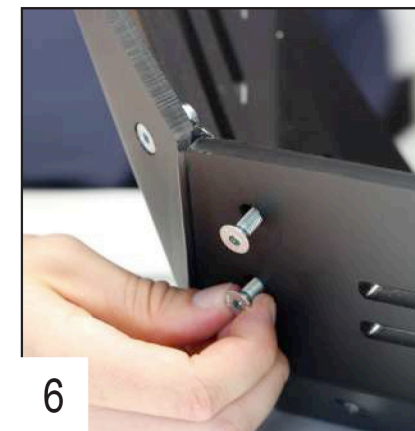

6
Use 2 screws to place correctly the aluminium part then tighten the top screw. And repeat the operation on the other side.

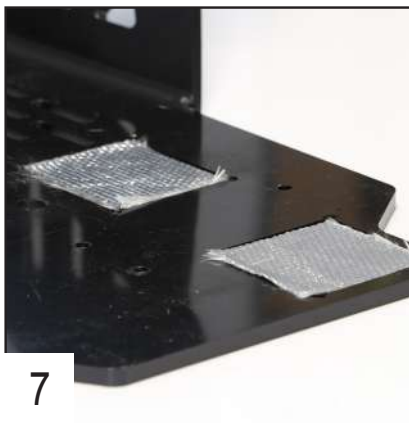

7

Place the heat shield stickers in the 2 machined spots.

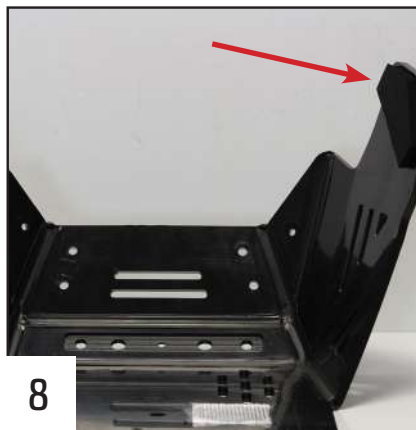

8

Place foam on each side of the skid plate to protect the cases.

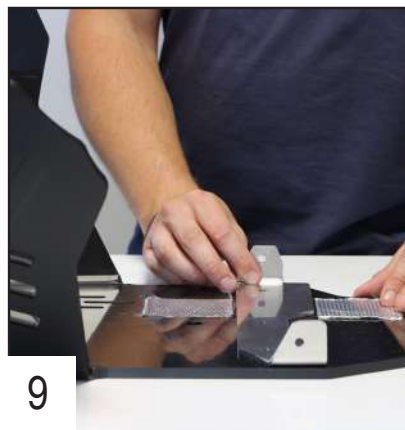

9

Place the aluminium part on the back of the skid plate.

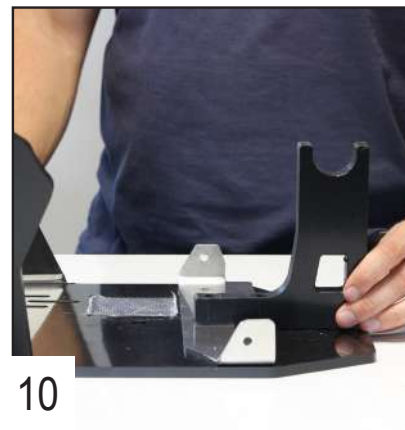

10

Place the 20mm plastic part on the back of the skid plate.

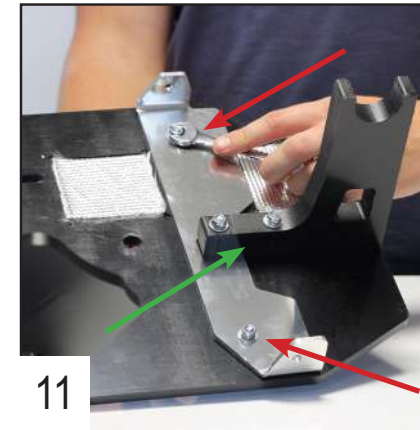

11

Place 2 TFHC 6x20mm screws + bolts and washers in the aluminum part. Then 2 TFHC 6x40mm screws + bolts and washers in the other holes and tighten.



12

Place the front part of the plate first and then fix the hook on the frame.

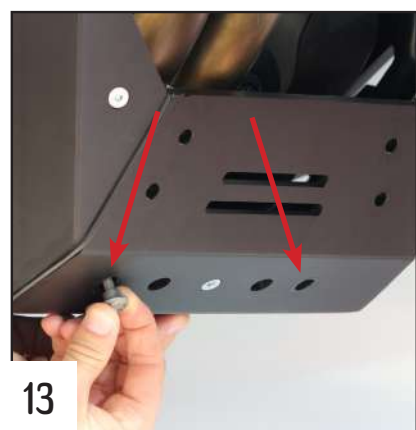

13

Place the special screws in the 2 holes without tightening.

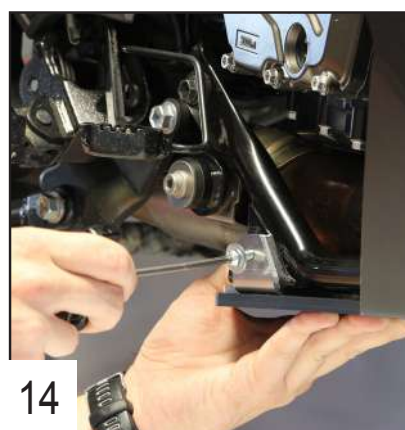

14

Place 2 TBHC 6x16 screws + EM6F bolts and M6 washers on each side of the frame and tighten.

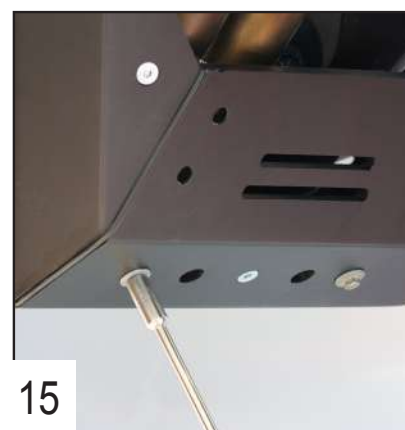

15

Tighten the 2 front special screws.

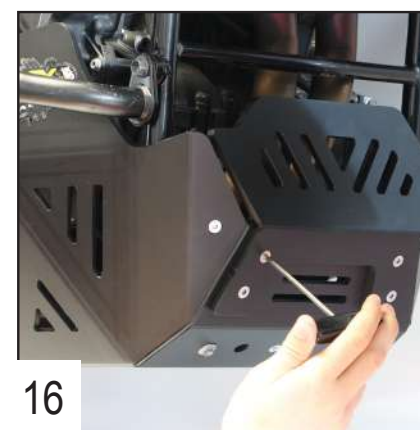

16

Place the mud guard using the 4 TFHC 6x30mm screws and tighten.

You're all ready to ride !